

Features:

- * Straight type.
- * High profile 8.5mm(0.335").
- * Mates with 0.46mm(0.018") square pin.

Material:

Housing: High temperature withstands IR and VPR soldering methods.
Contacts: Phosphor Bronze.
Plating: Gold plated over nickel.
 Tin plated over nickel.

Electrical Characteristics:

Current Rating: 1 AMP.
Insulator Resistance: 5000MΩmin. at DC 500V.
Contact Resistance: 20mΩmax. at DC 100mA.
Operating Temperature: -65°C~+125°C.
Max Processing Temperature: 230°C for 30~60 seconds.

Mechanical Characteristics:

Insertion Force: 140g avg.(0.46mm sq. pin)
Withdrawal Force: 114g avg.(0.46mm sq. pin)

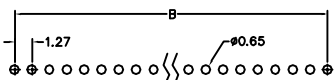
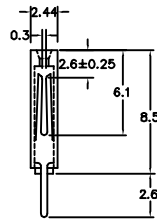
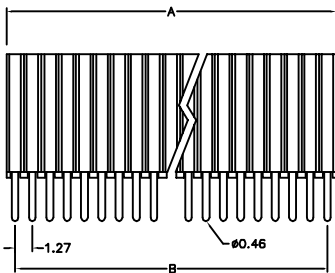

P.C. Board Layout

Position	3 Thru 36
Dimension	
A	1.27 X No. of Positions
B	1.27 X No. of Positions -1.27

Ordering information

PS26- 1 36 1 1
 Series Single Row No. of Pin Per Row 1: Gold Plated 2: Tin Plated 1: Straight